

ST agitator-pumps series is designed for medium and big refrigerators where **high reliability and long life** are required. These pumps are **very popular in both international and domestic markets** and are appreciated for their performances and **low energy consumption**.

- Type** AGITATOR-PUMP with immersed vertical axis.
- Windings** Single-phase motor with Class F.
- Motor body** Casing in extruded aluminium.
- Protection** IP 44 degree of protection from liquid seepage.
- Safety** Built-in thermal motor protection system.
- Ball bearings** Ø 8mm NSK, SKF or equivalent, in semi-rigid noise-insulated silicone casing..
- Motor shaft** AISI 303 INOX steel Ø 8mm.
- Fastening parts** INOX steel or anti-oxidant materials.
- Motor parts** Thermoplastic motor parts resistant to high temperature.
- Cooling system** Air cooled pump with a suction speed of 2,2 m/second.
- Water connection** Compatible with John Guest fittings.
- Operation** Power supply 220-240 Volts - 24 hours a day non stop. Clean water only.
- Regulations** Complying with EN60335-2-41:2003/A2:2010 and WEEE/RoHs directives.
- Note** Italian PATENTED component installed inside. Read manual for correct set up and use.

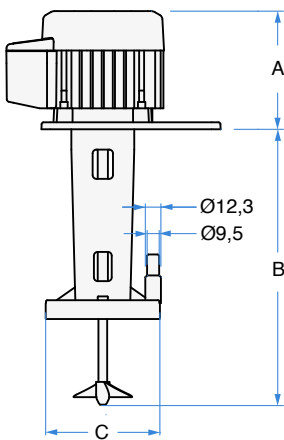

REGISTERED DESIGN

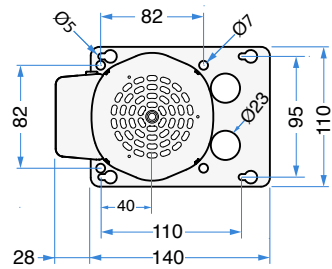
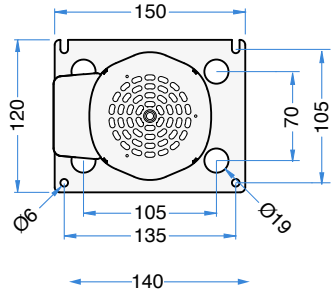
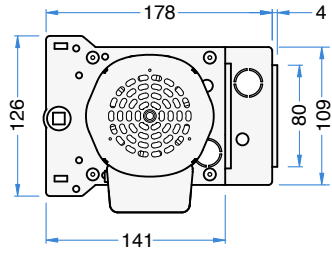
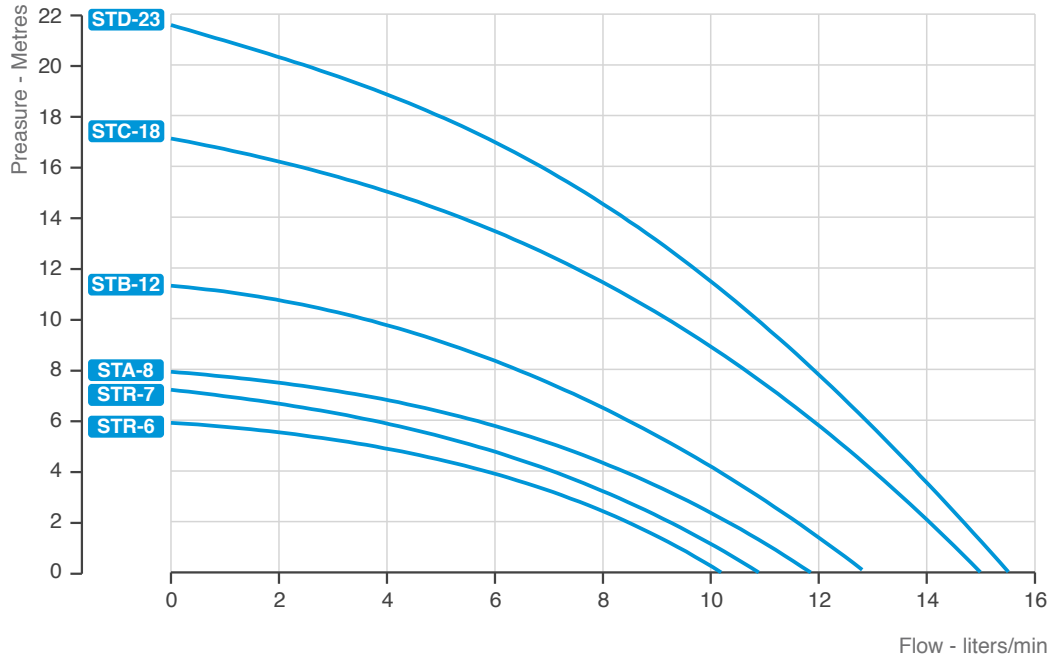

TYPE	Volt	Hz	Amp	Watt (in)	Rpm	A	B	C	Propeller Ø (mm)	Weight Kg
STR-6	220-240	50	0,18	46	2800	90	185	78	50 2 Blades 15°	1,48
STR-7	220-240	50	0,19	50	2800	90	220	90	50 2 Blades 15°	1,55
STA-8	220-240	50	0,25	54	2800	105	220	90	50 2 Blades 15°	1,85
STB-12	220-240	50	0,36	80	2800	105	220	90	50 2 Blades 15°	2,48
STC-18	220-240	50	0,46	99	2800	120	240	90	50 2 Blades 15°	2,57
STD-23	220-240	50	0,51	112	2800	120	240	90	50 2 Blades 15°	2,66